

# Masterplan design option 2

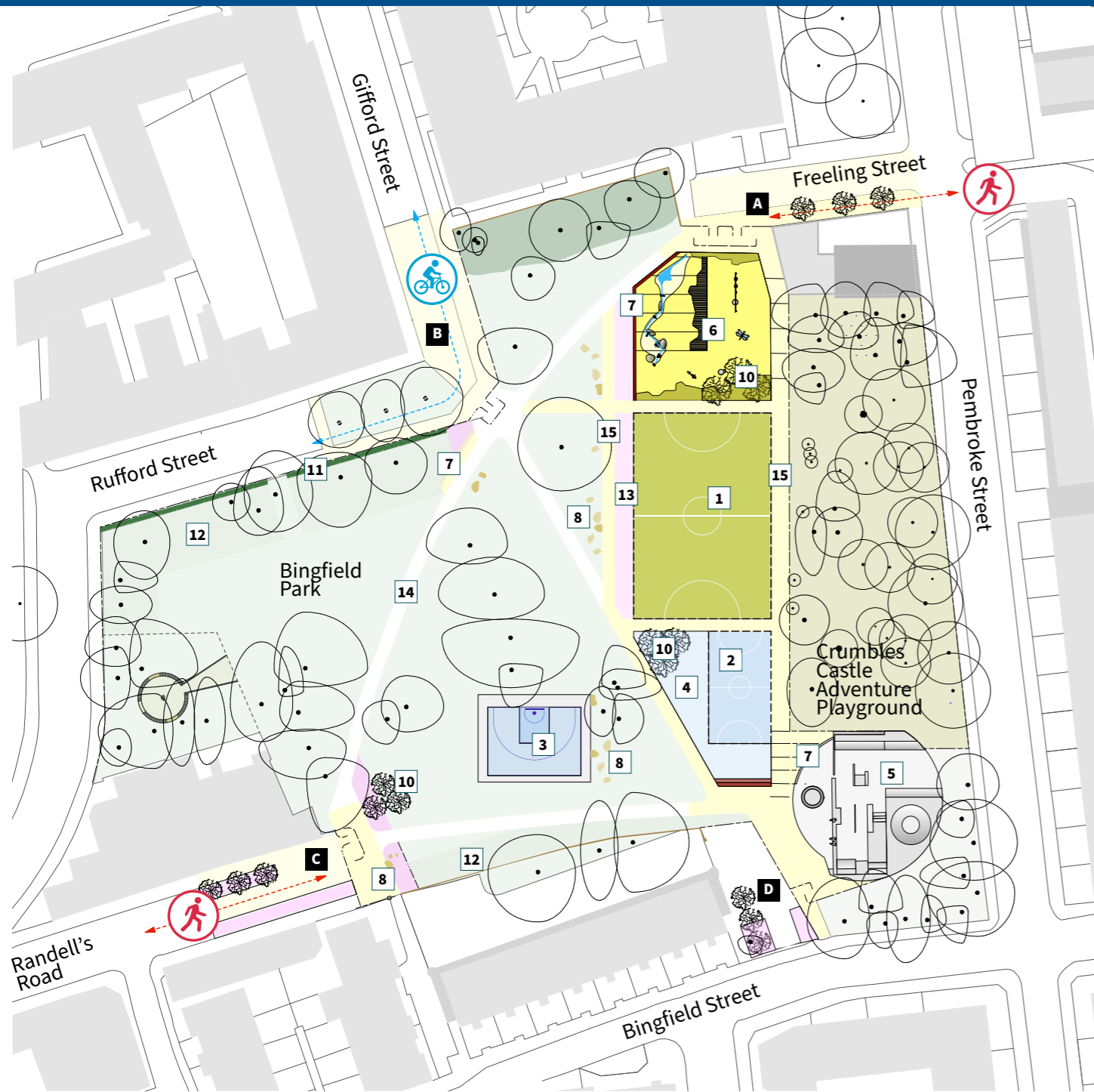

## Approaches to the park

- A** Freeling Street
  - New paving
  - Street trees
  - New park entrance gates and chicanes
- B** Gifford Street and Rufford Street
  - Two way cycle lane
  - New paving
  - Rain gardens
  - New park entrance gates and chicanes
- C** Randell's Road
  - New paving
  - Rain gardens
  - Street trees
  - New park entrance gates and chicanes
- D** Bingfield Street
  - New paving
  - Rain gardens
  - Street trees
  - New park entrance gates and chicanes
  - Separate access for vehicles and pedestrians

## Sport and play

- 1** Football pitch with artificial grass surfacing and floodlighting
- 2** Hard surface court for informal football and basketball
- 3** Basketball court (3 by 3)
- 4** Outdoor gym
- 5** Skate park / BMX street skate park
- 6** Play area for under 7s

## Seating

- 7** New seating
- 8** Stone boulders

## Trees and planting

- 10** New tree planting
- 11** Low wildlife hedge
- 12** Wildflowers
- 13** Rain gardens

## Access

- 14** Existing footpath retained
- 15** New footpath

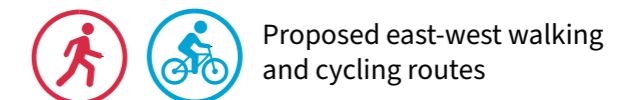

## Below is a visual of Masterplan design option 2



This option has the under 7's play area to the north with a smaller informal sport court to the south of the 3G football pitch. The pitch is raised slightly to the same level as the paths and surrounding area. The 3 v 3 basketball court stands alone and is unfenced. The Crumbles Castle building is partially retained and developed into an area for skating, BMX and Climbing/Parkour. There is a new wildflower meadow, native hedge and new seating and trees in both design options.