

# Margery Fry Court

1 to 10

18

Existing Zebra Crossing

Existing Resident Permit Holders Bay



Proposed Disabled Parking Bay location

## TUFNELL PARK ROAD

SOLO MOTORCYCLES ONLY

Existing Pay by Phone Bay

Existing Solo Motorcycles Bay

# Hollins House

25 to 30

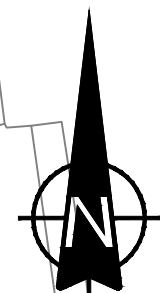

**ISLINGTON**  
 Environment & Regeneration  
 Public Realm Service  
 Assistant Director of Street Management  
 Bram Kainth  
 222 Upper Street, London, N1 1XR

Project  
Disabled Parking Bays

Drawing  
Tufnell Park Road

Scale	1:200	Date	05/02/2021
Designed	AJ	Checked	DK
Drawn	AJ	Approved	DK

Dwg. No.	Revision
1	